



**Legend**

-  Areas contain soils with 30 inches or more of provisionally useable material and have potential for conventional or modified conventional septic systems. There will be inclusions of soils in these areas that may only be suitable for LPP septic systems.
-  Areas contain soils with 24 to 29 inches or more of provisionally useable material and have potential LPP or ultra-shallow conventional septic systems. These areas will contain small areas of soil with greater than 30 inches of suitable soil material that can be used for conventional septic systems.
-  Areas contain soils with 20 inches or more of provisionally useable material and have potential low-profile chamber systems. These areas may contain small areas of soil with greater than 30 inches of suitable material. These areas may also have inclusions that are suitable for LPP, subsurface drip or ultra-shallow conventional septic systems. No reduction in line length may be taken.
- UN** Areas unsuitable for septic.

- \*Soil borings flagged in the field and GPS located.
- \*Not a survey.
- \*Septic system setbacks listed below for new lots.
  - 1) 10' from property lines.
  - 2) 50' from wells for primary systems (100' if in saprolite).
  - 3) 50' from wells for repair systems (100' if in saprolite).
  - 4) 50' from surface waters (streams, ponds, lakes).
- \*Any mechanical disturbances such as grading, cutting and filling of the suitable soil areas can render areas unsuitable for future septic systems.
- \*See accompanying report for additional information.
- \*Base map acquired from Person County GIS website.
- \*Due to soil variability, CCSC cannot guarantee that the areas shown as suitable will be permitted by the local Health Department.
- \*The preliminary (approximate) soil lines cannot be used as legal descriptions for purposes of a land transfer or legal documentation.
- \*Additional field work may be required for a septic permit (septic system field layout/design)



GRAPHIC SCALE  
1" = 150'

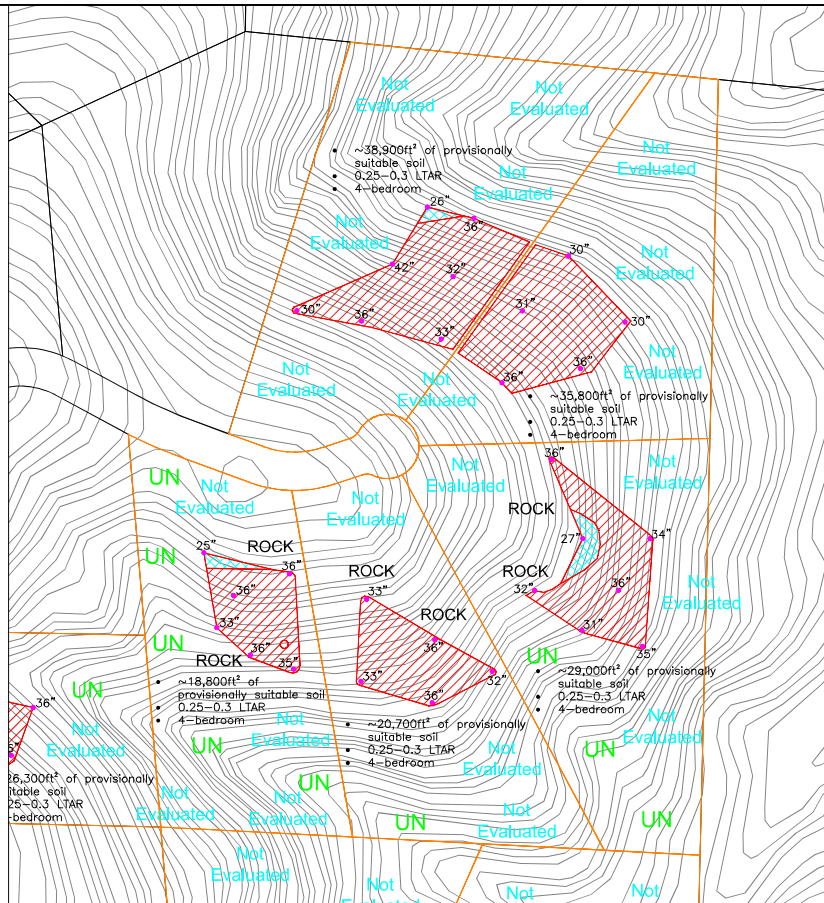
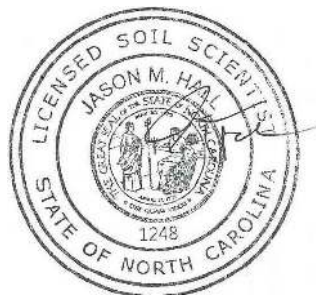

Central Carolina Soil Consulting, PLLC 1900 South Main Street, Suite 110 Wake Forest, North Carolina 27587 Phone (919)569-6704 Fax (919)569-6703	Soils Evaluation Lots 29-33 Red Mountain Estates Person County, North Carolina	Job#: 4419 Drawn By: JR Date: 02/01/2023
---	---	--