

General Notes

- Area by Coordinate Method
- No Public Horizontal Control Monument found within 2000'
- All buildings, structures, easements and utilities are not necessarily depicted herein.
- See Monumentation in #5 near utility raised structure.
- All distances are horizontal ground distances at U.S. survey feet.
- This survey performed without benefit of title examination and is made subject to any document which may affect subject property.
- Environmental conditions, wetlands, jurisdictional waters or other conditions which may be regulated by Federal, State or local authorities were not investigated. Riparian buffers and other restrictions may be applicable.
- Surface and subsurface utilities depicted herein are based on visible evidence only. Utility companies should be contacted for information regarding any utilities.
- The NAD 83(2011) bearing base produced with RMC GPS observations. The network positional accuracy of the RMC derived positional information is 1 cm horizontal position and 3 cm vertical position as referenced to NAD 83(2011).
- Flood zone plotted by graphical method (see color and adjacent maps).

© Copyright, S.D. Puckett & Associates, Inc. unauthorized reproduction prohibited by law.

HURSEL B JOHNSON FAMILY, LLC
DB 1519/755

LINE BEARING DISTANCE

L1	S 49°31'20" E	91.88
L2	S 49°42'18" E	125.00
L3	S 52°32'35" E	125.00
L4	S 43°32'52" E	89.19
L5	S 54°34'20" E	211.48
L6	S 44°23'05" E	497.30
L7	S 44°23'05" E	174.61
L8	S 40°14'24" E	158.18
L9	S 33°38'48" E	508.64
L10	S 44°28'28" E	118.14
L11	S 44°28'28" E	129.70
L12	S 44°28'28" E	131.71
L13	S 44°52'33" E	112.81
L14	S 52°28'42" E	274.90
L15	S 52°28'42" E	521.34
L16	S 52°28'42" E	500.03
L17	S 52°28'42" E	274.90
L18	S 52°28'42" E	521.34
L19	S 52°28'42" E	500.03
L20	S 52°28'42" E	274.90
L21	S 52°28'42" E	521.34
L22	S 52°28'42" E	500.03
L23	S 52°28'42" E	274.90
L24	S 52°28'42" E	521.34
L25	S 52°28'42" E	500.03
L26	S 52°28'42" E	274.90
L27	S 52°28'42" E	521.34
L28	S 52°28'42" E	500.03
L29	S 52°28'42" E	274.90
L30	S 52°28'42" E	521.34
L31	S 52°28'42" E	500.03
L32	S 52°28'42" E	274.90
L33	S 52°28'42" E	521.34
L34	S 52°28'42" E	500.03
L35	S 52°28'42" E	274.90
L36	S 52°28'42" E	521.34
L37	S 52°28'42" E	500.03
L38	S 52°28'42" E	274.90
L39	S 52°28'42" E	521.34
L40	S 52°28'42" E	500.03
L41	S 52°28'42" E	274.90
L42	S 52°28'42" E	521.34
L43	S 52°28'42" E	500.03
L44	S 52°28'42" E	274.90
L45	S 52°28'42" E	521.34
L46	S 52°28'42" E	500.03
L47	S 52°28'42" E	274.90
L48	S 52°28'42" E	521.34
L49	S 52°28'42" E	500.03
L50	S 52°28'42" E	274.90
L51	S 52°28'42" E	521.34
L52	S 52°28'42" E	500.03
L53	S 52°28'42" E	274.90
L54	S 52°28'42" E	521.34
L55	S 52°28'42" E	500.03
L56	S 52°28'42" E	274.90
L57	S 52°28'42" E	521.34
L58	S 52°28'42" E	500.03
L59	S 52°28'42" E	274.90
L60	S 52°28'42" E	521.34
L61	S 52°28'42" E	500.03
L62	S 52°28'42" E	274.90
L63	S 52°28'42" E	521.34
L64	S 52°28'42" E	500.03
L65	S 52°28'42" E	274.90
L66	S 52°28'42" E	521.34
L67	S 52°28'42" E	500.03
L68	S 52°28'42" E	274.90
L69	S 52°28'42" E	521.34
L70	S 52°28'42" E	500.03
L71	S 52°28'42" E	274.90
L72	S 52°28'42" E	521.34
L73	S 52°28'42" E	500.03
L74	S 52°28'42" E	274.90
L75	S 52°28'42" E	521.34
L76	S 52°28'42" E	500.03
L77	S 52°28'42" E	274.90
L78	S 52°28'42" E	521.34
L79	S 52°28'42" E	500.03
L80	S 52°28'42" E	274.90
L81	S 52°28'42" E	521.34
L82	S 52°28'42" E	500.03
L83	S 52°28'42" E	274.90
L84	S 52°28'42" E	521.34
L85	S 52°28'42" E	500.03

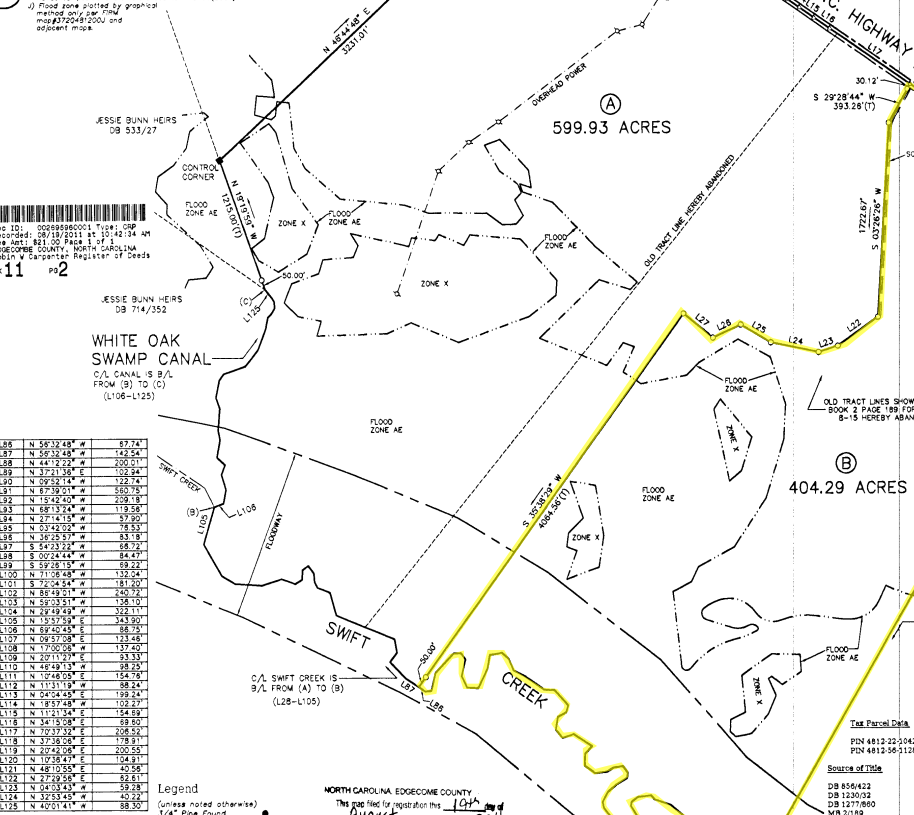

Legend

(Unless noted otherwise)

- Pipe Found
- Nail Found
- Concrete Monument
- Centrina
- Right of Way
- Boundary Line
- Overhead Utilities
- CHD
- Total Distance (ft)

S.D. PUCKETT & ASSOCIATES
PROFESSIONAL LAND SURVEYORS (C-0506)
1655 N. C. 50
CRENSHAW, N.C. 27522
P. 919.528.8900
WWW.PUCKETTSURVEYS.COM

NORTH CAROLINA, EDGECOMBE COUNTY
The plat filed for registration this 19th day of August, 2011
in NC 11 State 2
at Rocky Mount, N.C.
I, Robert W. Carpenter, Register of Deeds
Do hereby certify that this is a true and correct copy of the original as filed for registration.



Surveyor's Certificate - State of N.C.

I certify that this plat was drawn under my supervision from an actual survey made under my supervision, deed description reviewed in (see source documents), that the boundaries not surveyed are indicated as shown from information in -- that the ratio of section is 1:10,000; and that this plat meets the requirements of the Standards of Practice for Land Surveying in North Carolina (21 NCAC 58.1606) This 7th day of March, 2011.

Stephen M. Puckett
Stephen M. Puckett
Professional Land Surveyor L-3991

I, Stephen M. Puckett, certify to the following:
D. That this plat is of a Survey of another category, such as a recombination of existing parcels, a court-ordered survey or other exception to the definition of subdivision.

Stephen M. Puckett
Stephen M. Puckett L-3991

N.C. State Plane Coordinate System NAD 83(2011)

N.G.S. MONUMENT (LEGGETT)
PID (E72910)
NAD 83 (2007)
N: 814,935.68
E: 2,419,865.99

State of North Carolina
County of Edgecombe
I, Franklin W. Bowers, Register of Deeds of Edgecombe County, certify that this map or plat is which this certification is affixed meets all statutory requirements for registration.
Franklin W. Bowers 8/19/11
Register of Deeds

We hereby certify that we are the owners of the property shown and described herein, which was conveyed to us by (see source of title) and that said property qualifies as an exception to the provisions of the Edgecombe County Unified Development Ordinance pursuant to subsection NCSS-1534-355.

Franklin W. Bowers
Nancy W. Bowers
Pinning Director

Recombination Plat for:
Franklin Wilson, Jr.
&
Nancy W. Bowers
March 7, 2011
Township No. 5, County of Edgecombe, State of N.C.

The Parcel Data
DB 4812-22-0162
PIN 4812-56-1103

Source of Title
DB 656/423
DB 1230/23
DB 127/060
MB 2/119

Owner
Nancy W. Bowers
1005 Country Club Dr.
New Bern, NC 28562

Franklin Wilson, Jr.
PO Box 1177
Rocky Mount, NC 27802

Graphic Scale (1"=600')

Plot Side 2

Plot Side 2